

## Toepassingsmogelijkheden U-keerwanden (agrarisch)

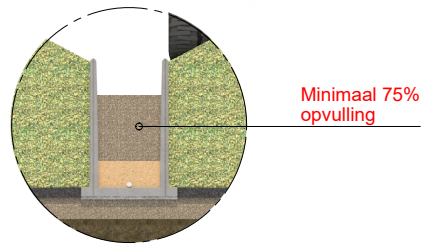

**10T** aslast

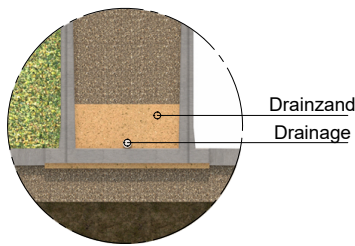
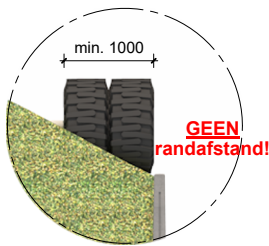
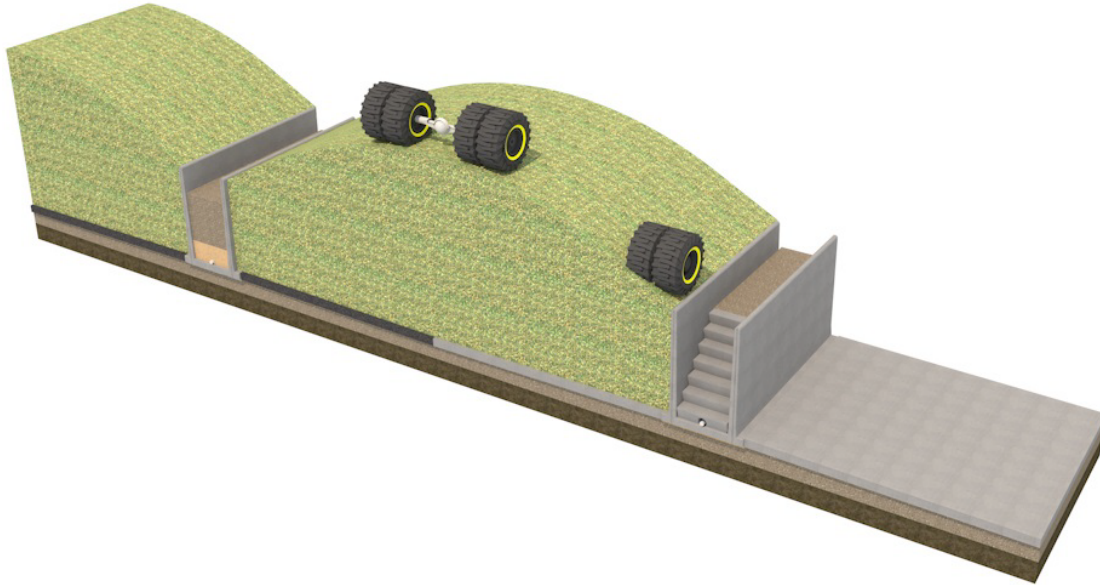
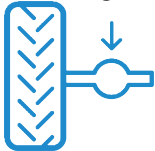

**U300**

**Aanvulling vrijstaand**

**Onverhard**

**Verhard**

N.v.t.

160mm tegen wand

**15T** aslast

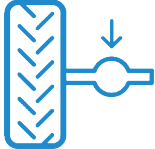

**U150HAK**

290mm over hak

140mm tot bk hak

**U175HAK**

440mm over hak

140mm tot bk hak

**U200HAK**

500mm over hak

140mm tot bk hak

**U250HAK**

540mm over hak

140mm tot bk hak

**U300HAK**

620mm over hak

160mm tot bk hak

**Afwijkende toepassing/belastingen op aanvraag**

Max.  
**28°**



Max. silage height  
panel height + 0.5m



Dry matter content



**NO** Store silage at  
max. 800kg per m<sup>3</sup>

D: Füllgutklassen 1 u.  
2a nach DIN 11622-2

This silage clamp  
complies with:

- ▶ **BS 5502-22**  
Agricultural building and structures
- ▶ **BRL 2812**  
Agricultural concrete products
- ▶ **BS EN 13369**  
Precast concrete products